

**1** Remove the handles on fridge/door if possible. Ensure the surface is clean and grease-free and dry.

**2** Get the necessary tools ready – a squeegee applicator (or a credit card will also work), masking tape, scissors, a scalpel or cutting/stanley knife.

**3** Align vinyl sheet with the top fridge edge and ensure it is straight and centred. Leave enough vinyl to wrap around the side door edges.

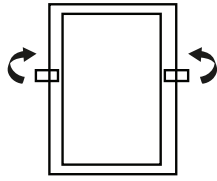

**4** Secure and tape your vinyl sheet in place with masking tape on either side.

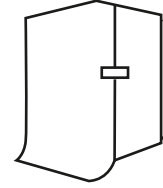

**5** Cut away any excess vinyl sheet along bottom of the door.

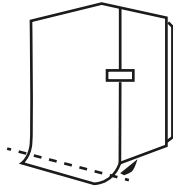

**6** Put a strip of masking tape across the middle of sheet and ensure that tape reaches from one side of fridge/door to the other. Remove tape from step 4.

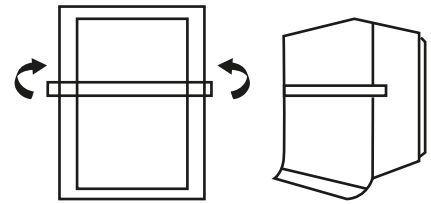

**7** With your vinyl hanging down and away from the surface, peel the top of vinyl sheet off from the application backing for about 20cm. and then cut away the backing sheet.

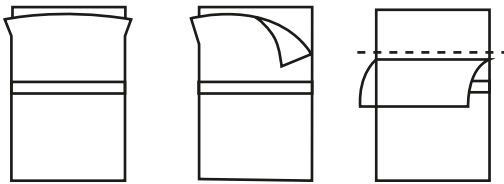

**8** Take hold of the vinyl sheet by the top left/right corners, and pull upwards, keeping the vinyl taut to avoid creases and stick down at the top edge of the fridge/door.

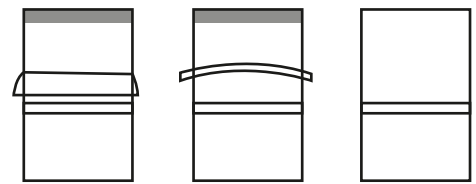

**9** Rub down the vinyl from left to right using the applicator, being careful not to trap any air or creases in the vinyl. Don't stress about small air bubbles if they do occur – these are easily removed afterwards with a needle by making a small pin prick in the air bubble and then rubbing/pressing out the bubble.)

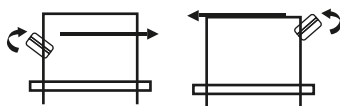

**10** Reach up behind the vinyl and holding the vinyl away from the fridge, slowly pull down more of the backing sheet for another 10-15 cm, and then rub down onto the fridge surface, working from left to right with the squeegee/card. Work downwards in manageable sections of about 10-15 cm, and then rub down the vinyl with the applicator from left to right. Continue until the length of vinyl is applied.

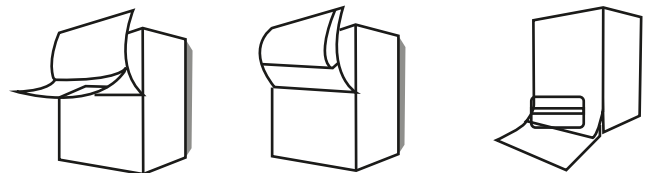

**11** Wrap vinyl around the side edges. For a split door (top and bottom), measure and cut vinyl sheet into correct lengths for each section. Then apply to each door section as explained above.

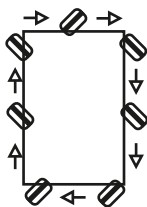

**12** Trim the edges of the vinyl away with the cutting knife/scalpel, taking care not to cut or damage your fridge surface or rubber seals.

